

LOCATION DETAILS

Location details of Mouza-Mahesh, J.L. No.-15 under Police Station Serampore, Ward No. 16, within the limits of Serampore Municipality, District Hooghly, Pin Code- 712201, West Bengal, With Project Name **Solaris City Serampore Phase 1C** with clear demarcation of land dedicated for the project along with its boundaries including the latitude and longitude of the project.

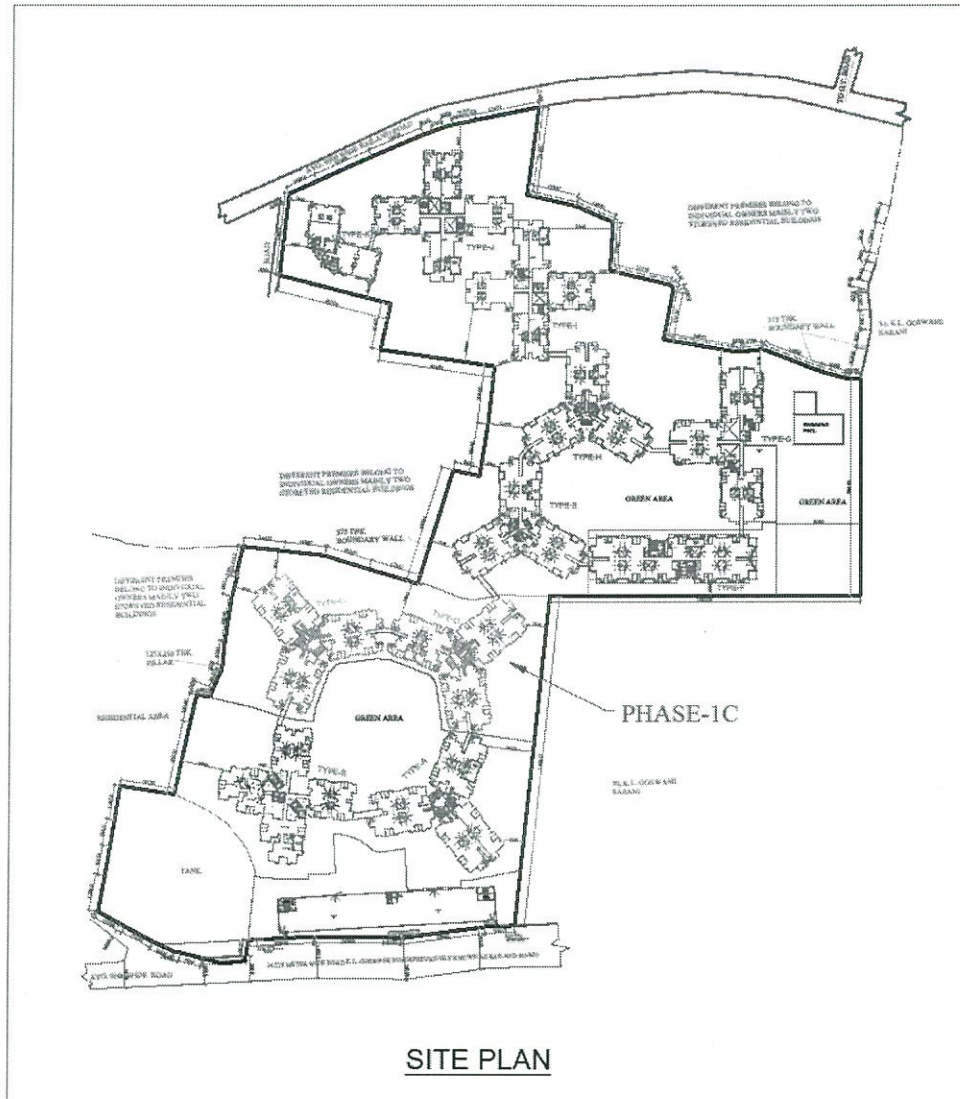

The latitude and longitude of the center of the project:

LATITUDE	LONGITUDE
22°44'16.47"N	88° 20'48.81"E

Place: Kolkata

Date: 07.07.2023

Page 1 of 1

Yours Faithfully

EDEN REALTY VENTURES PVT. LTD.

[Signature]
Director

Eden Realty Ventures Pvt. Ltd. | Metropolitan Building
7 J L Nehru Road | Kolkata 700 013 | India

+91 33 66264100 | info@ervpl.com | edenrealtygroup.com

CIN: U170101WR2003DTC095820